

# Universal Access Design Tour

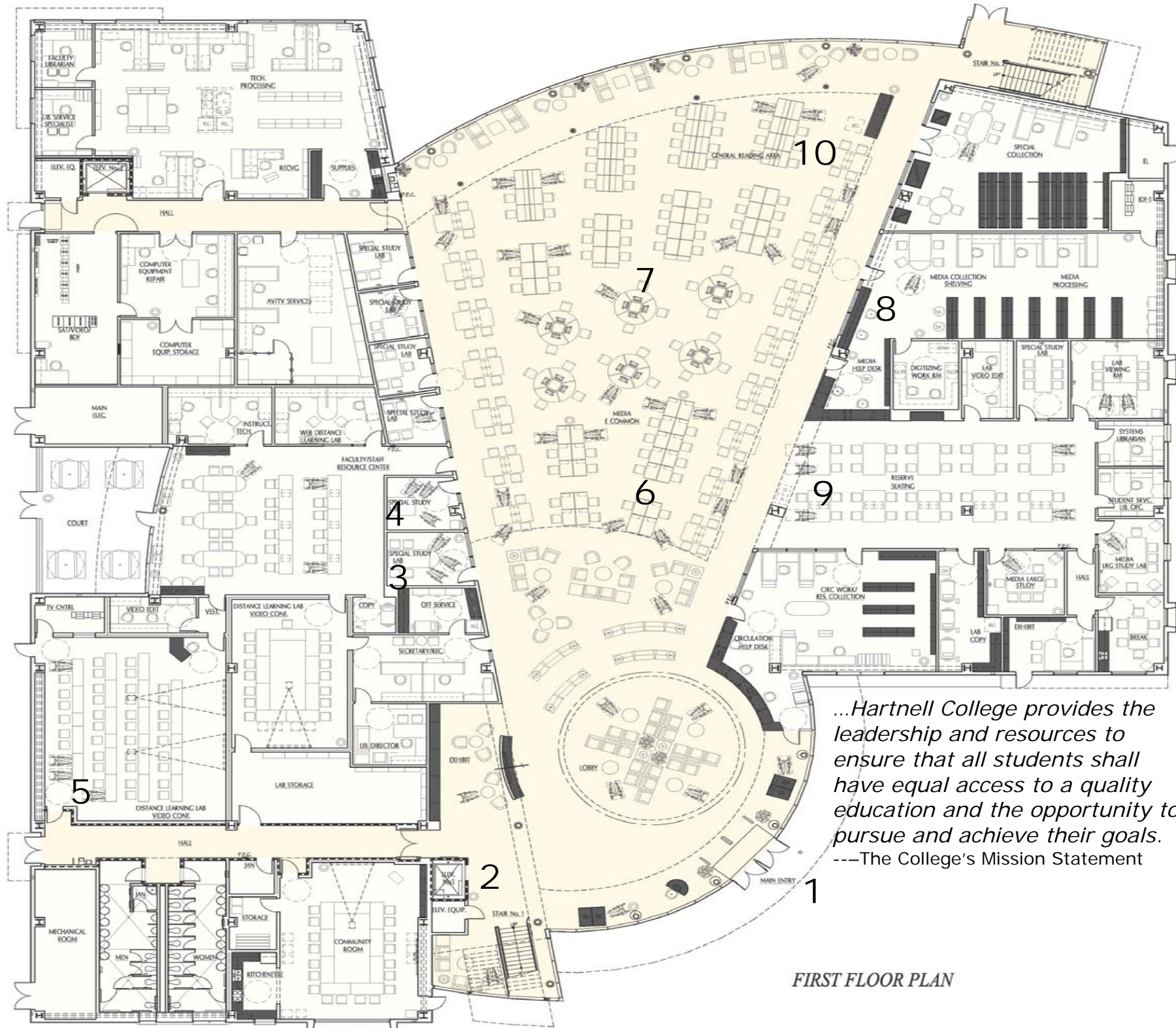

# Universal Access Design Tour



...Hartnell College provides the leadership and resources to ensure that all students shall have equal access to a quality education and the opportunity to pursue and achieve their goals.  
 ---The College's Mission Statement



**1.** Push button automatic doors are located at the front entrance



**2.** Elevator access to the second floor, located off the front entrance



**3.** Study Room designated for users of assistive technologies

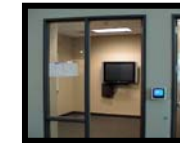

**4.** Study Room designated for users of assistive technologies



**5.** Motorized adjustable table found in the distance learning classroom



**6.** Universal access station with assistive technology in the Media Center area



**7.** Universal access station. One of several located through out LRC



**8.** Tables with unrestricted ends to allow for wheelchair access are through out



**9.** Higher table tops allow for wheelchair access in the Reserve area



**10.** Carrels with higher tops allow for easy wheelchair access

# Universal Access Design Tour



# Universal Access Design Tour

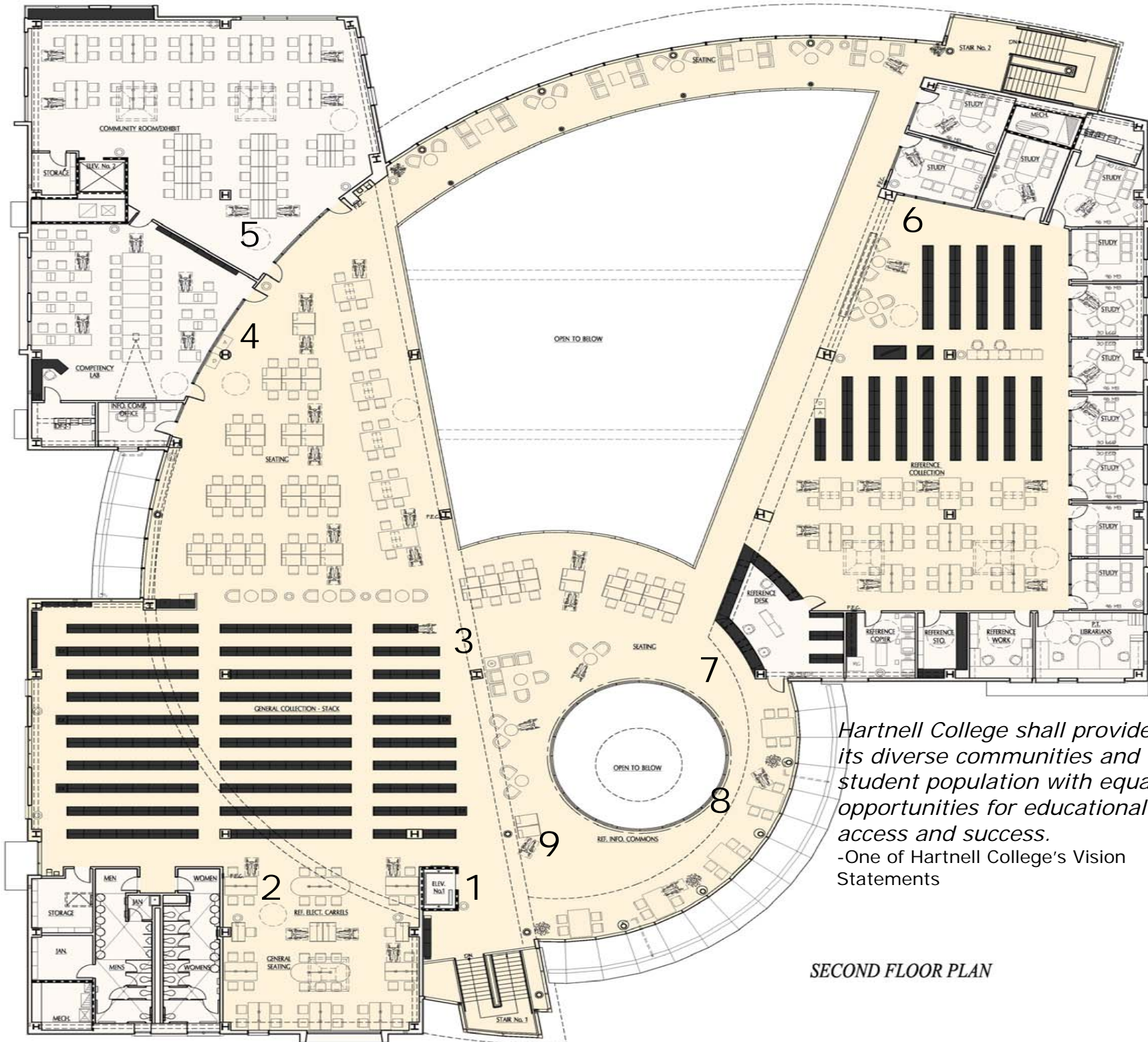

*Hartnell College shall provide its diverse communities and student population with equal opportunities for educational access and success.*  
 -One of Hartnell College's Vision Statements

SECOND FLOOR PLAN



**1.** Elevator access to the second floor, located off the front entrance.



**2.** Quiet study area with accessible tables and adjustable carrels.

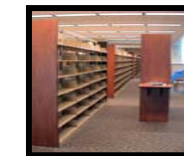

**3.** Look-up Station at the end of the book stacks. Wheelchair height.



**4.** Study Carrel on the 2nd floor. Larger workspace and adjustable/higher desktop for wheelchair.



**5.** Quiet Study Area with higher table tops for wheel chair access.



**6.** Tables with unrestricted ends and higher table tops allow for wheelchair access are through out.

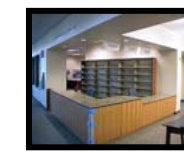

**7.** Lower counter tops at both reference/circulation counter.



**8.** Tables with higher tops to allow for wheelchair access are through out.

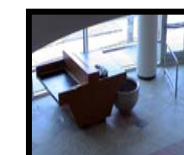

**9.** Self-Check station with lower counter top.